

NOTE: Setting up your email accounts on your Sat-Fi2 app must be done while using LTE or Wi-Fi connection.

The Sat-Fi2 app will request to enable Two-step verification and create an App Password for Yahoo.

Follow the instructions to complete these steps:

1. To turn on the Two-step verification, sign in to your Yahoo email account.
2. Click on your name, then select **Account Info**.
3. Select **Account Security** and enable **Two-step verification**.

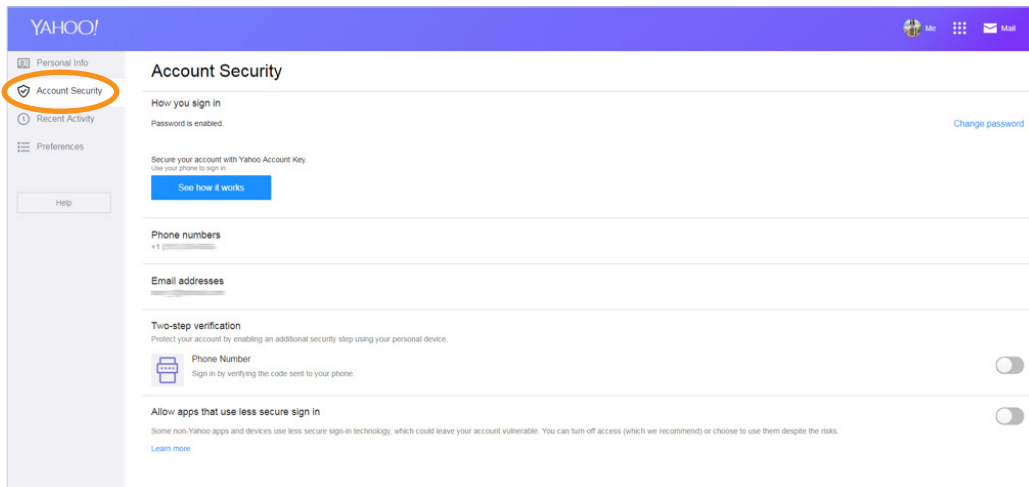

4. A pop-up will be displayed asking to enter your mobile number in order to send an SMS or call you.

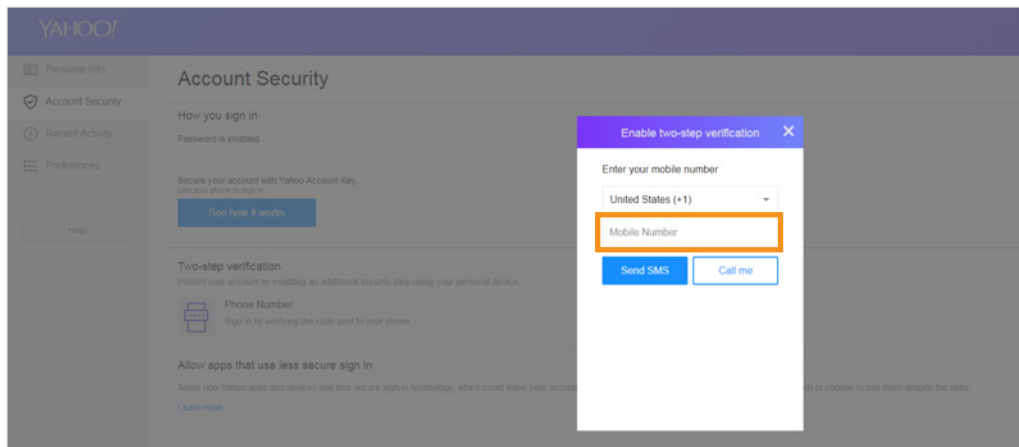

- Once the code is received and entered, another pop-up will be displayed giving you the option to Create app passwords. Click on this option.

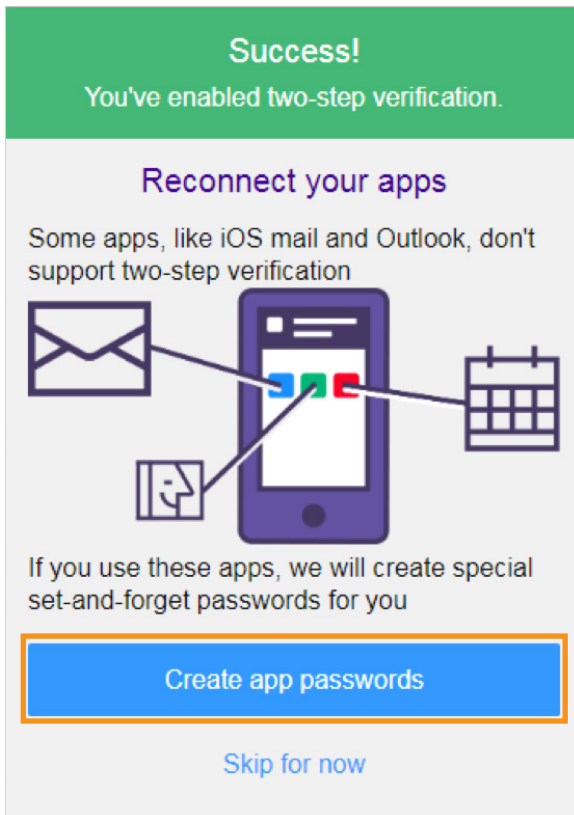

- Under the App Password pop-up click on the **Select your app** dropdown menu and choose Other App. Then enter Sat-Fi2 App.
- Click on **Generate** and the app password for Sat-Fi2 App will be displayed.

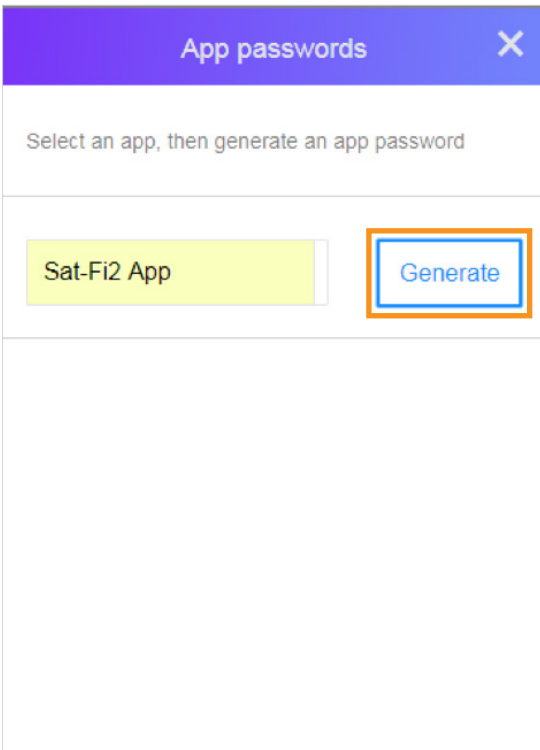

Use this password when linking your AOL e-mail in your Sat-Fi2 App.

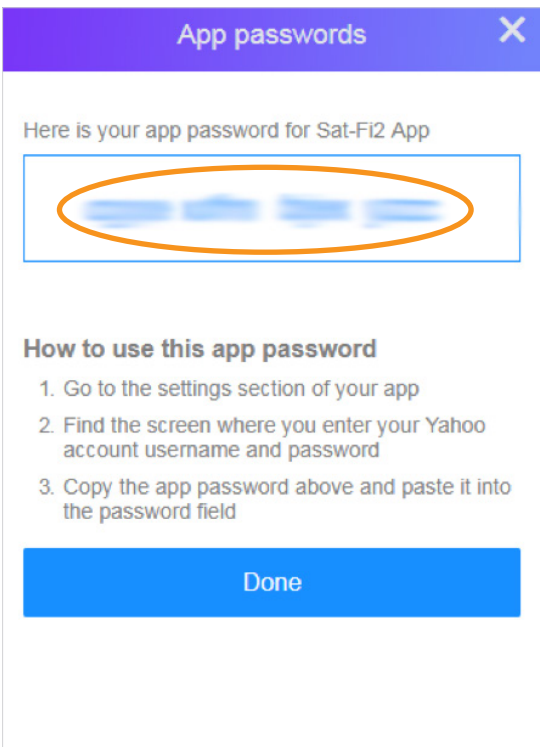

8. Select **Done** and close the pop-up window.
9. The Sat-Fi2 app will then be listed under the Manage app passwords section.

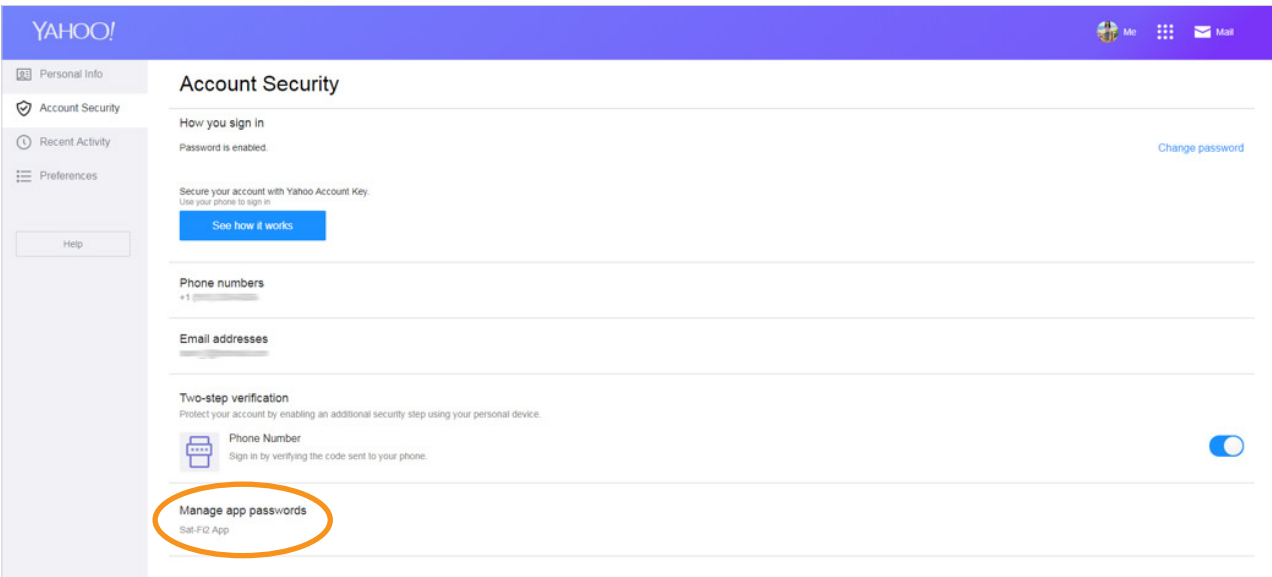

If the Two-step verification is not enabled:

1. Click on your name, then select **Account Info**.
2. Select **Account Security**.
3. Enable **Allow apps that use less secure sign in**.

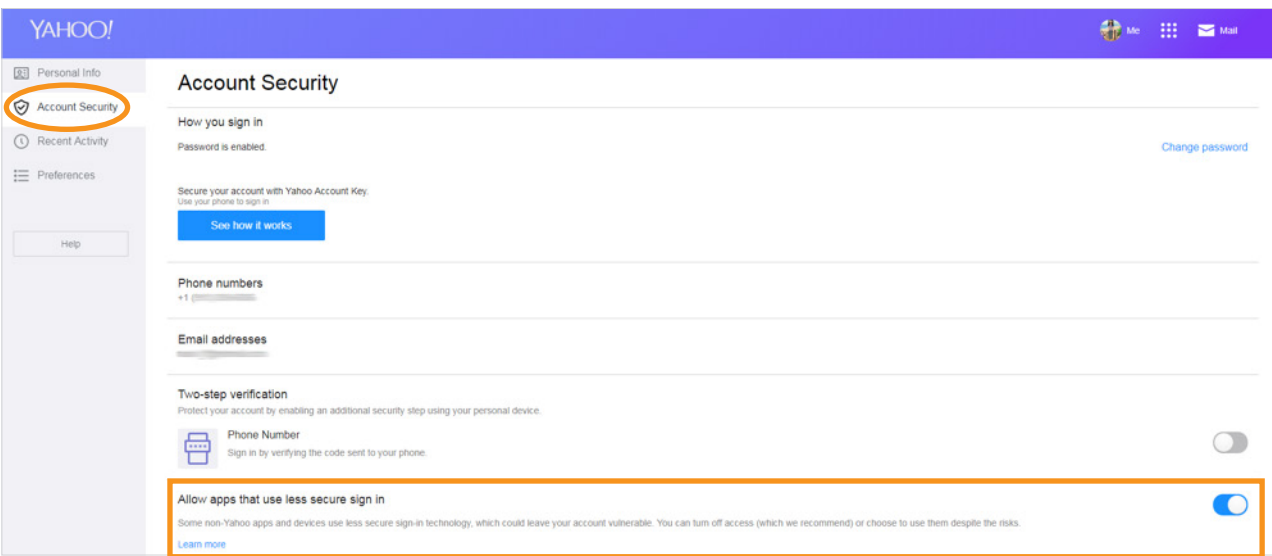

4. You are ready to add the account to the Sat-Fi2 App.