

**NOTE: Setting up your email accounts on your Sat-Fi2 app must be done while using LTE or Wi-Fi connection.**

The Sat-Fi2 app will request to enable Two-step verification and create an App Password for Gmail.

Follow the instructions to complete these steps:

1. Login to your Gmail account.
2. Select the small circle on the top right corner (with your initials) and a pop-up window will be displayed. Then click on the **Google Account** tab.

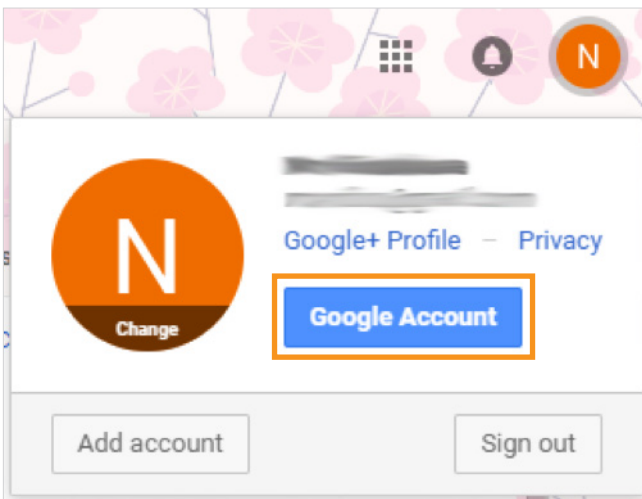

3. Select **Security** from the list on the left. Then, select the **2-Step Verification** which by default is set to OFF.

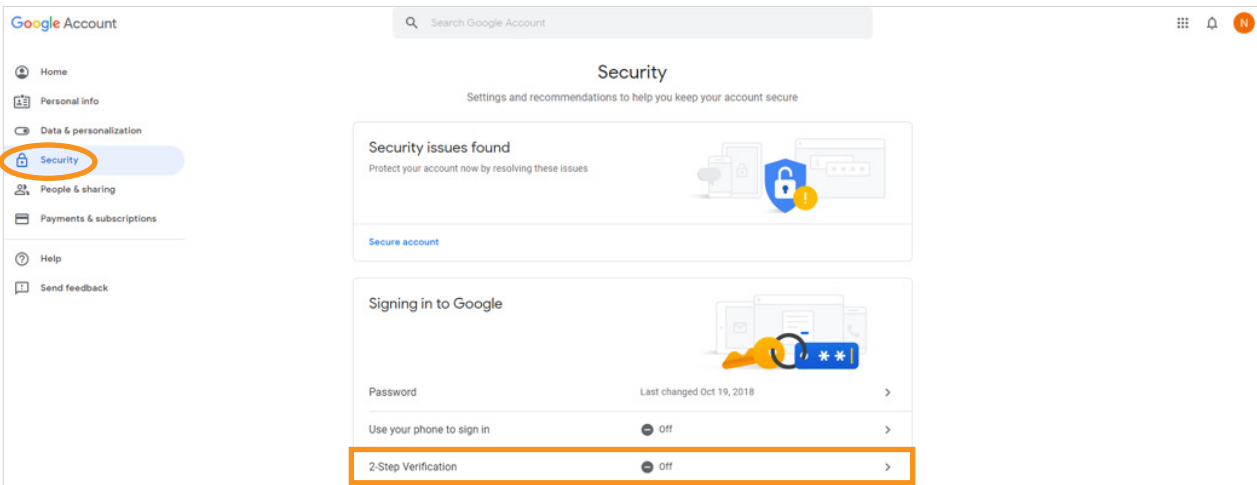

- The 2-Step Verification screen will show up. Click **Get Started**.

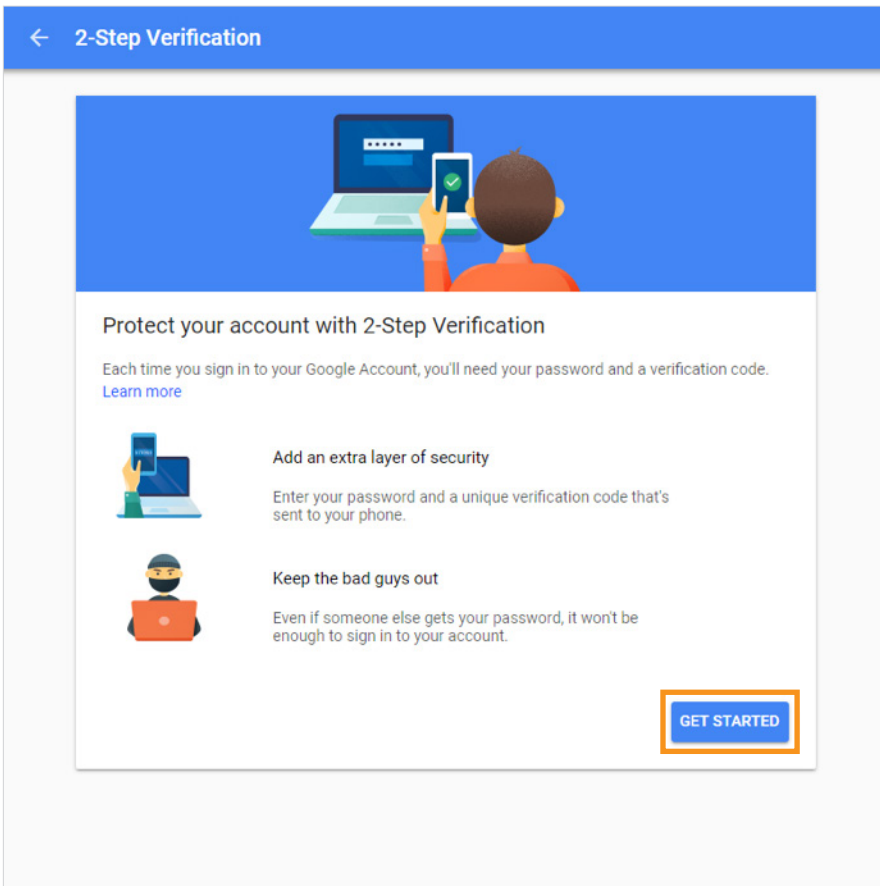

- Google will ask you to enter your password.

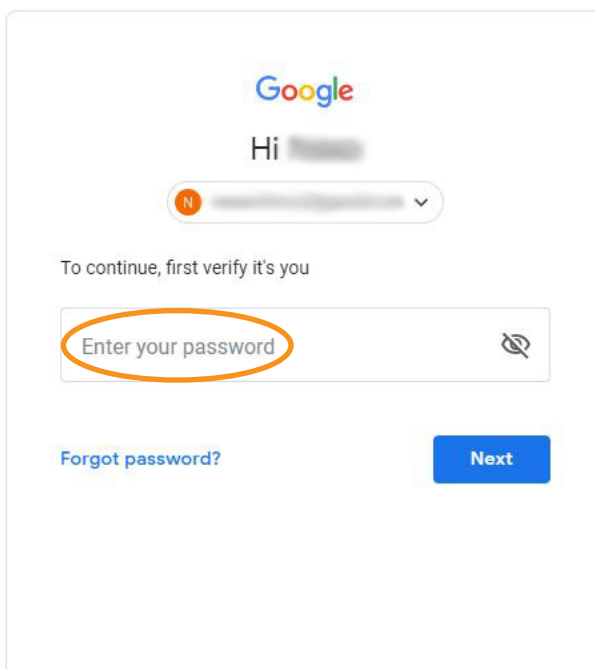

6. After logging in, you will be asked to set up your phone. Follow the prompts regarding the verification code.
7. Once the verification code is received and entered, you will be asked if you want to **Turn On** the 2-Step Verification.

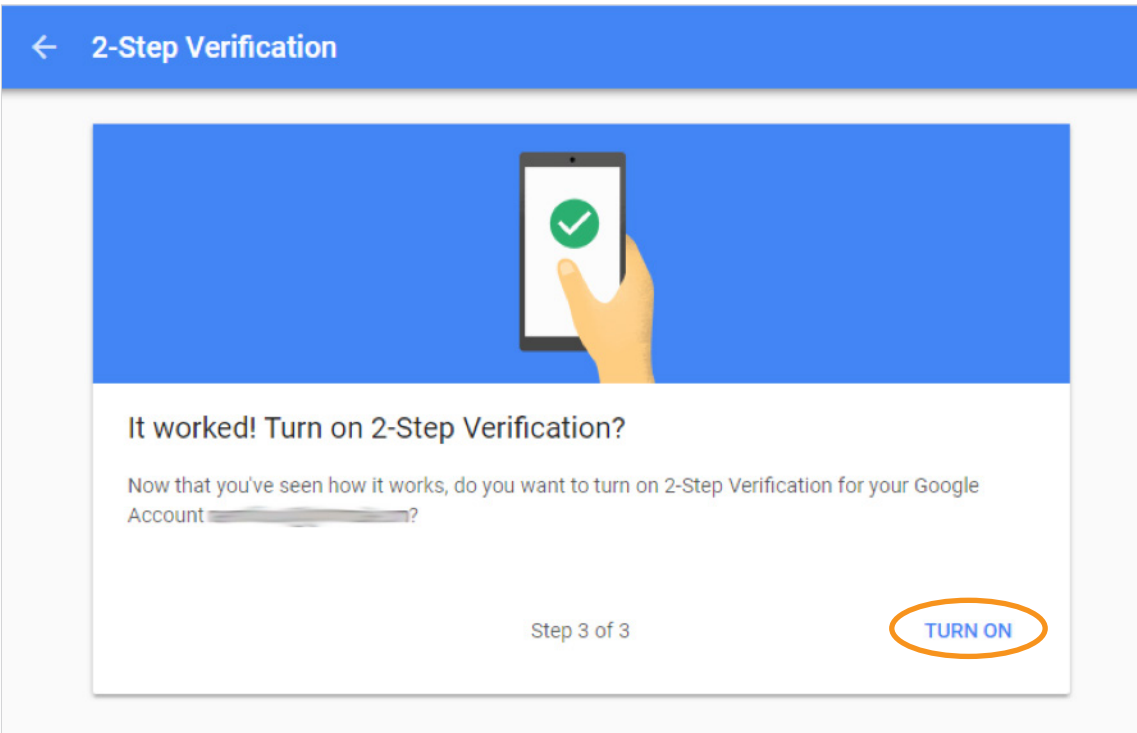

8. Once it's Turned On, click on the back arrow next to 2-Step Verification. This will bring you back to the **Security** menu.

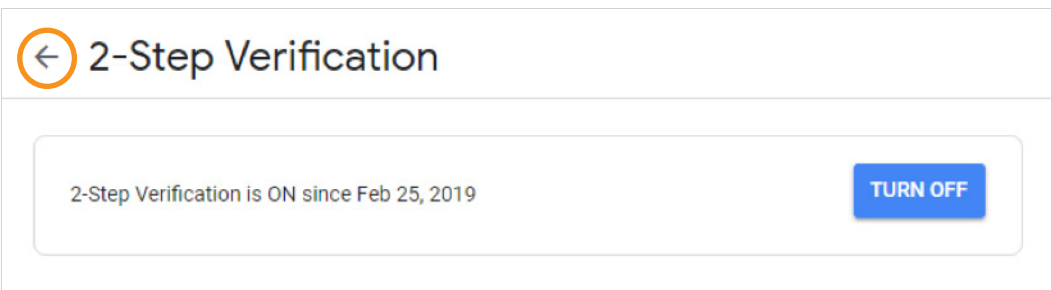

9. On the **Signing in to Google** section, click on **App passwords**.

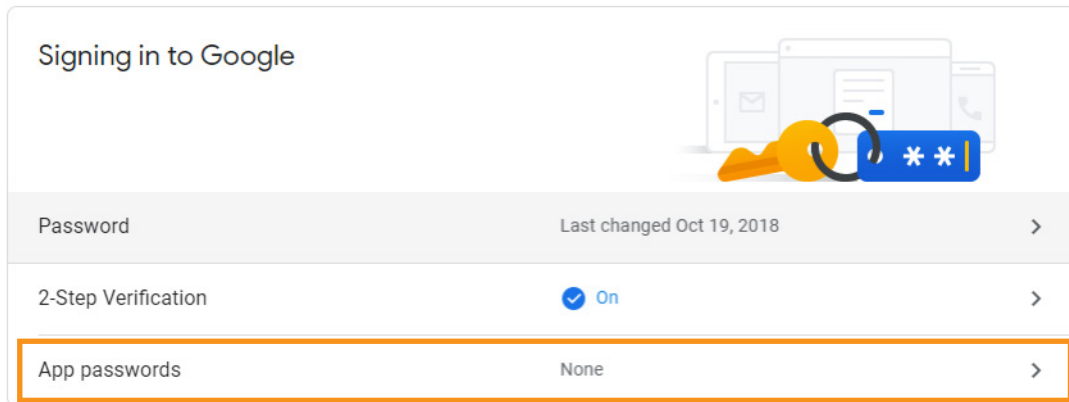

10. Google will ask you to enter your password.
11. After logging in, you will receive a 6-digit verification code via text or e-mail address. Enter the code once it's received.
12. Next, you will be prompted to select the app and device you want to generate the app password for.
13. From the **Select app** drop down menu, select Other, type in Sat-Fi2 and click on **Generate**.
14. A pop-up window will be displayed and will provide the Generated app password.

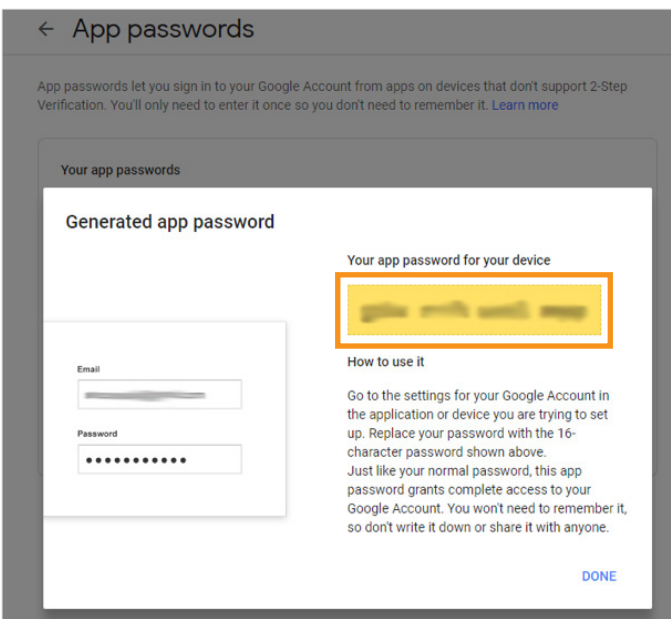

15. Follow the instructions to enter the App password on your mobile device.
16. Select **Done**.