

**NOTE: Setting up your email accounts on your Sat-Fi2 app must be done while using LTE or Wi-Fi connection.**

The Sat-Fi2 app will request to enable Two-step verification and create an App Password for AOL.

Follow the instructions to complete these steps:

1. To turn on the Two-step verification, sign in to your AOL email account.
2. Click on **Options** under the username, then select **Account Info**.

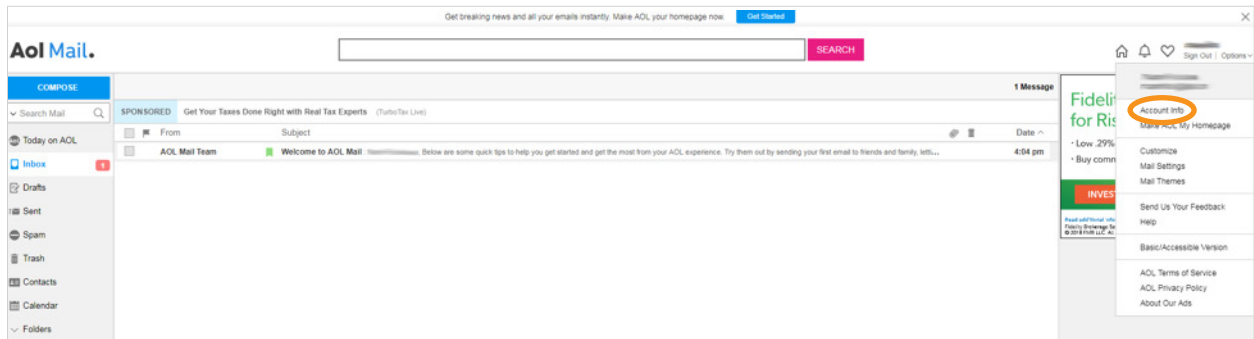

3. Select **Account Security** and enable **Two-step verification**.

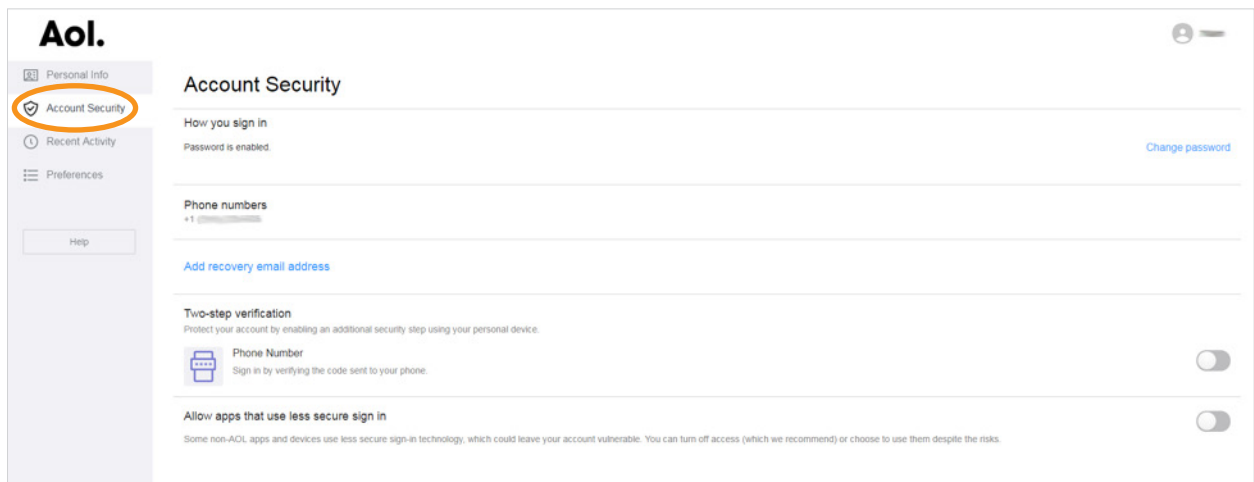

4. A pop-up will display asking to enter your mobile number in order to send an SMS or call you.

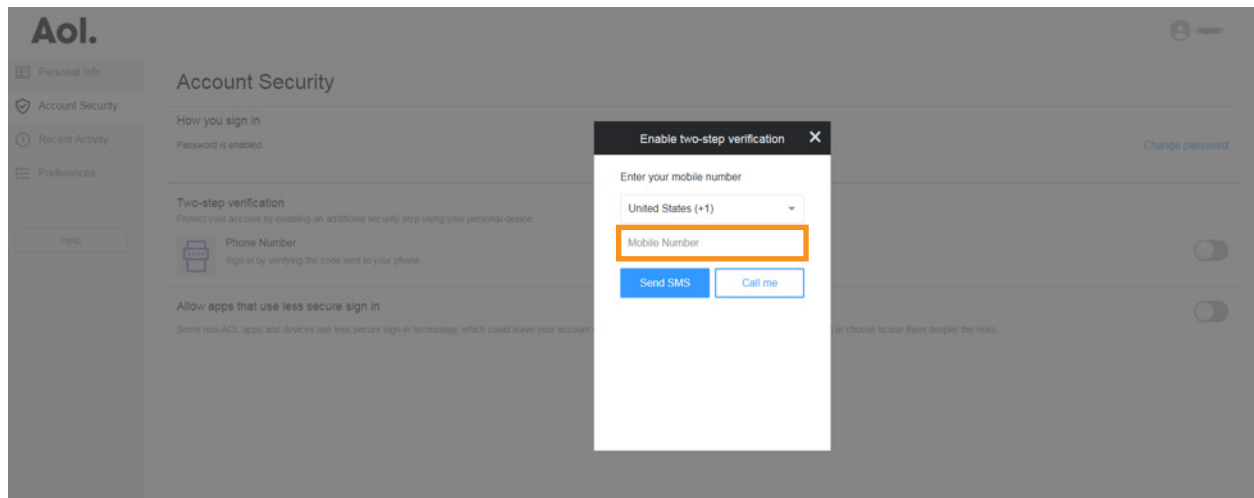

5. Once the code is received and entered, another pop-up will be displayed, giving you the option to create app passwords. Select this option.

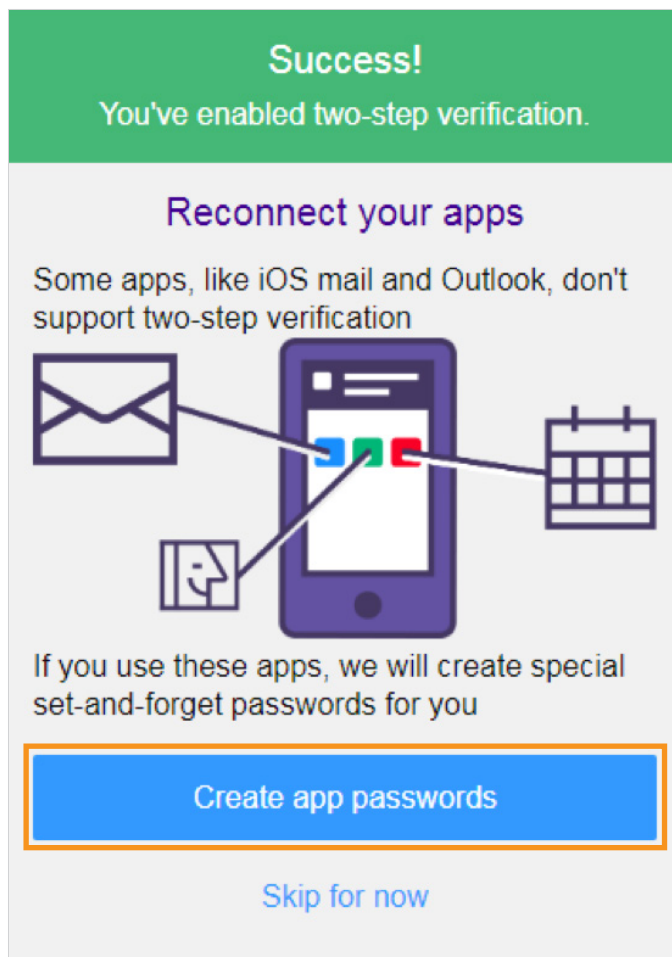

- Under the App Password pop-up click on the **Select your app** dropdown menu and choose Other App. Then enter Sat-Fi2 App.
- Click on **Generate** and the app password for Sat-Fi2 App will be displayed.

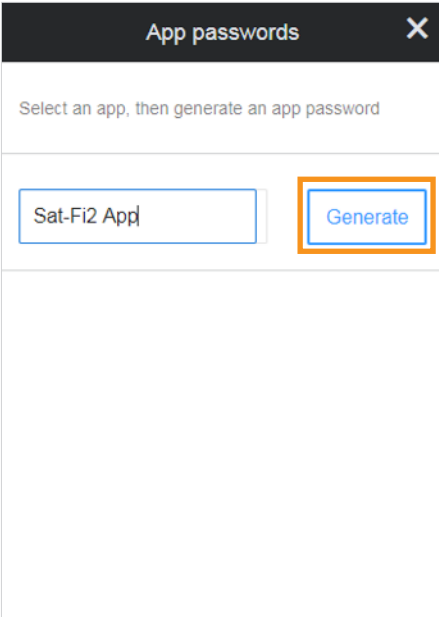

Use this password when linking your AOL e-mail in your Sat-Fi2 App.

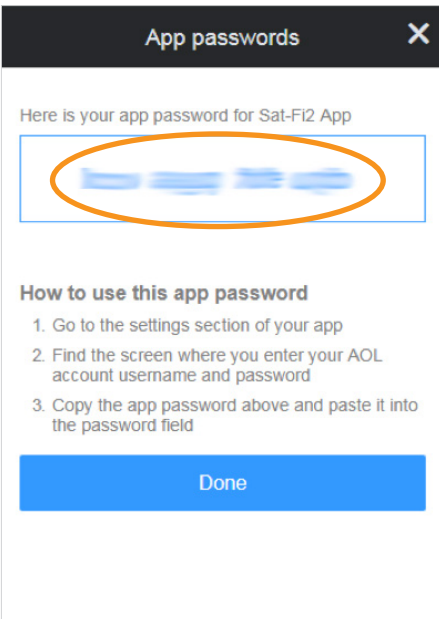

- Select **Done** and close the pop-up window.

- The Sat-Fi2 app will then be listed under the Manage app passwords section.

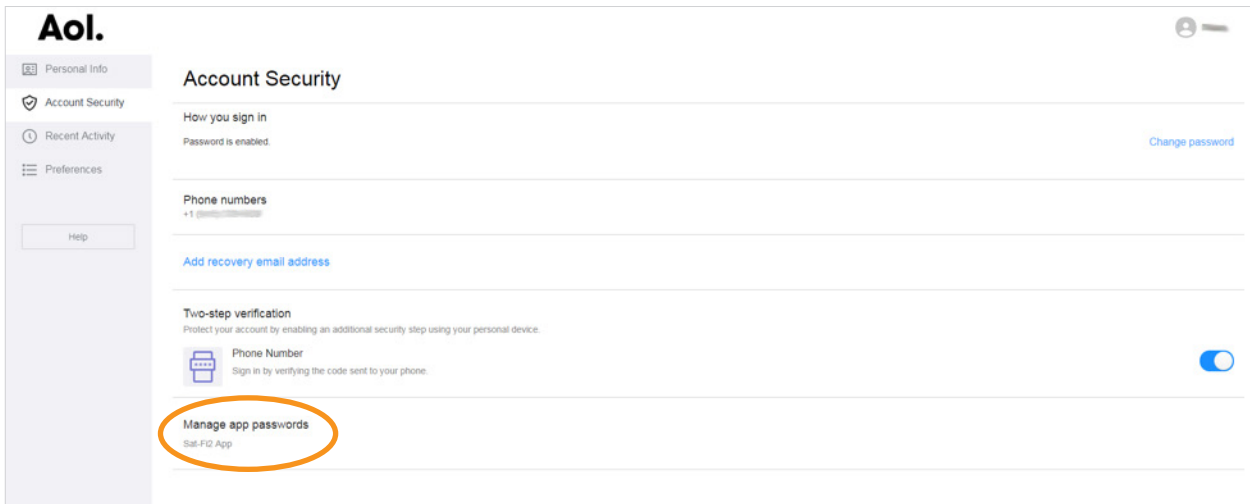

If the Two-step verification is not enabled:

- Click on **Options** under the username, then select **Account Info**.
- Select **Account security**.
- Enable **Allow apps that use less secure sign in**.

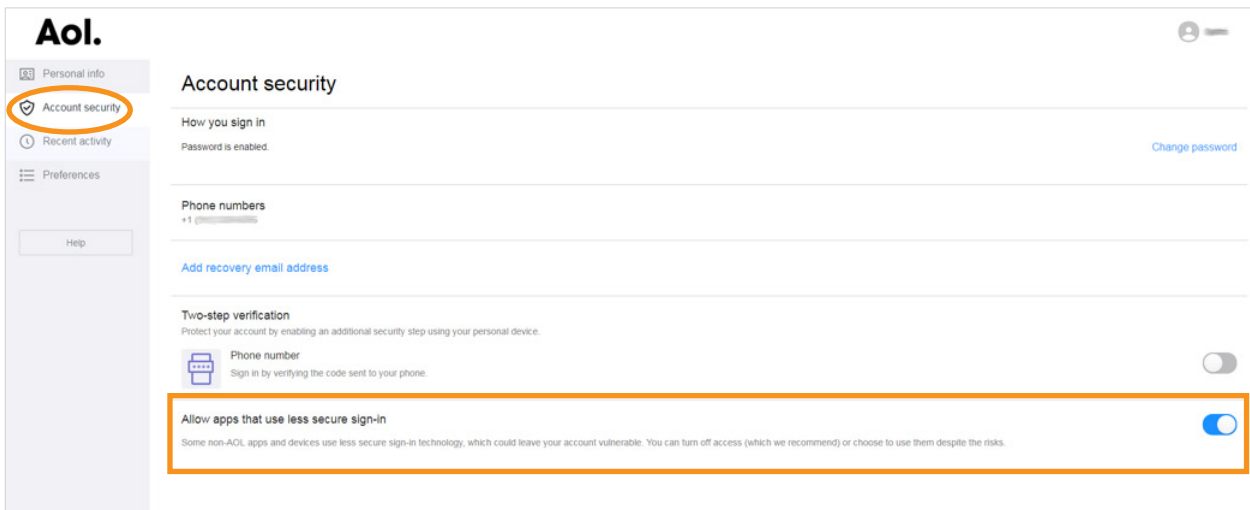

- You are ready to add the account to the Sat-Fi2 App.